

## AXIAL SPRAY NOZZLE UGN-820A

### Specifications

To be mounted on surface of ductwork.  
It is used in applications where it is necessary to avoid bulky in the duct because of the type and the quantity of transported material (eg fibers, paper, leather).  
70° hollow cone jet.  
Spray jet in line with water entry.  
Flow rate 11 lt/min (0.2 lt/sec) at 1 bar, 25 lt/min (0,4 lt/sec) at 4 bar.  
Coupling 3/4" gas male. Case material brass.  
Dimensions  $\varnothing$  40 x H35 mm.  
Weight 130 g.

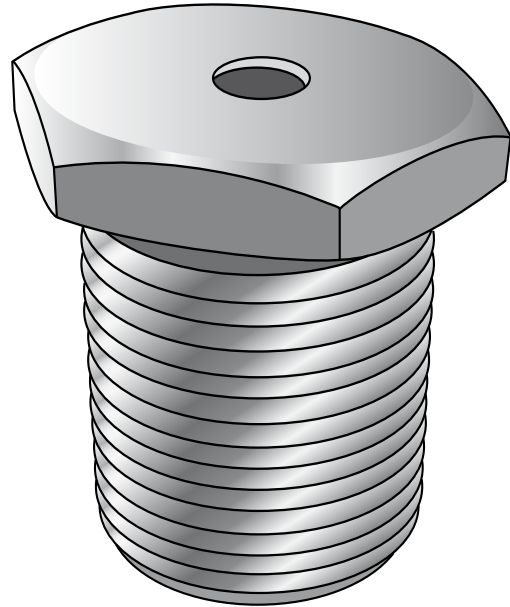

### mounting details

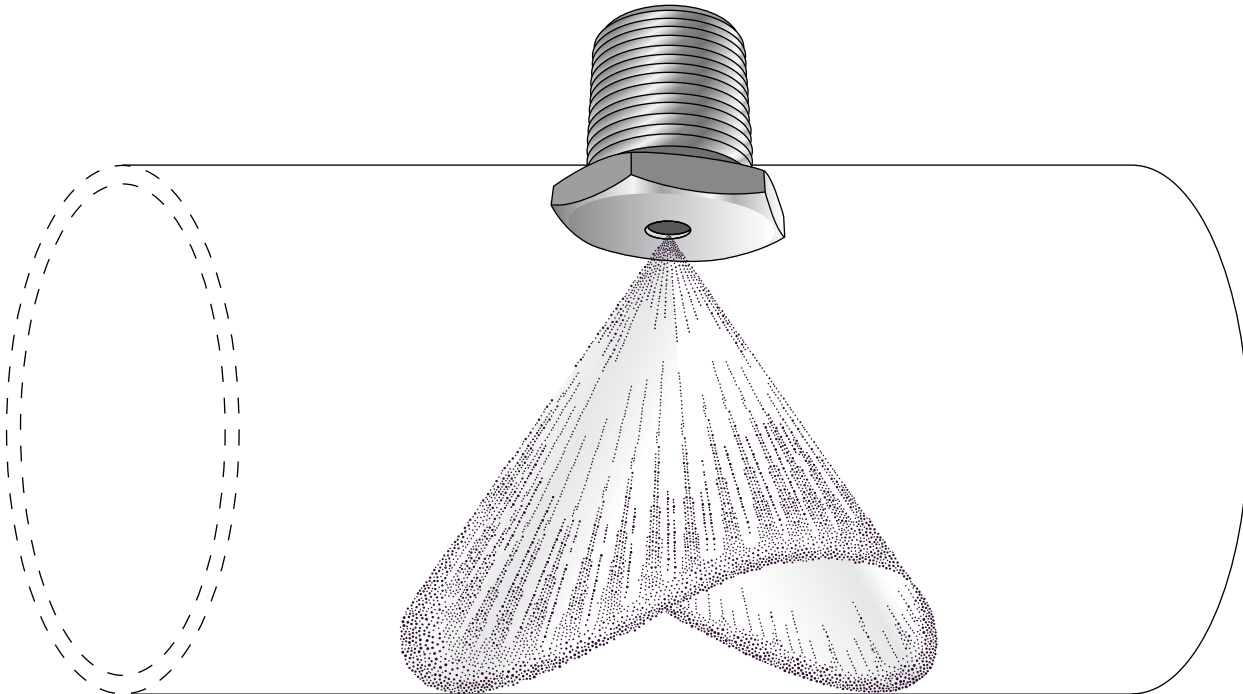

Note: install a pair of nozzles to achieve an effective extinguishing barrier. The two nozzles of the pair are mounted on the sides, horizontally opposite each other.

